

# FRONT STRUT ASSEMBLY

A9

WHEEL ADJUST MOUNT COMPLETE  
PR8-32H-FSASSM

\* ## - TO SPECIFY COLOR

WH - WHITE

BK - BLACK

SL - SILVER

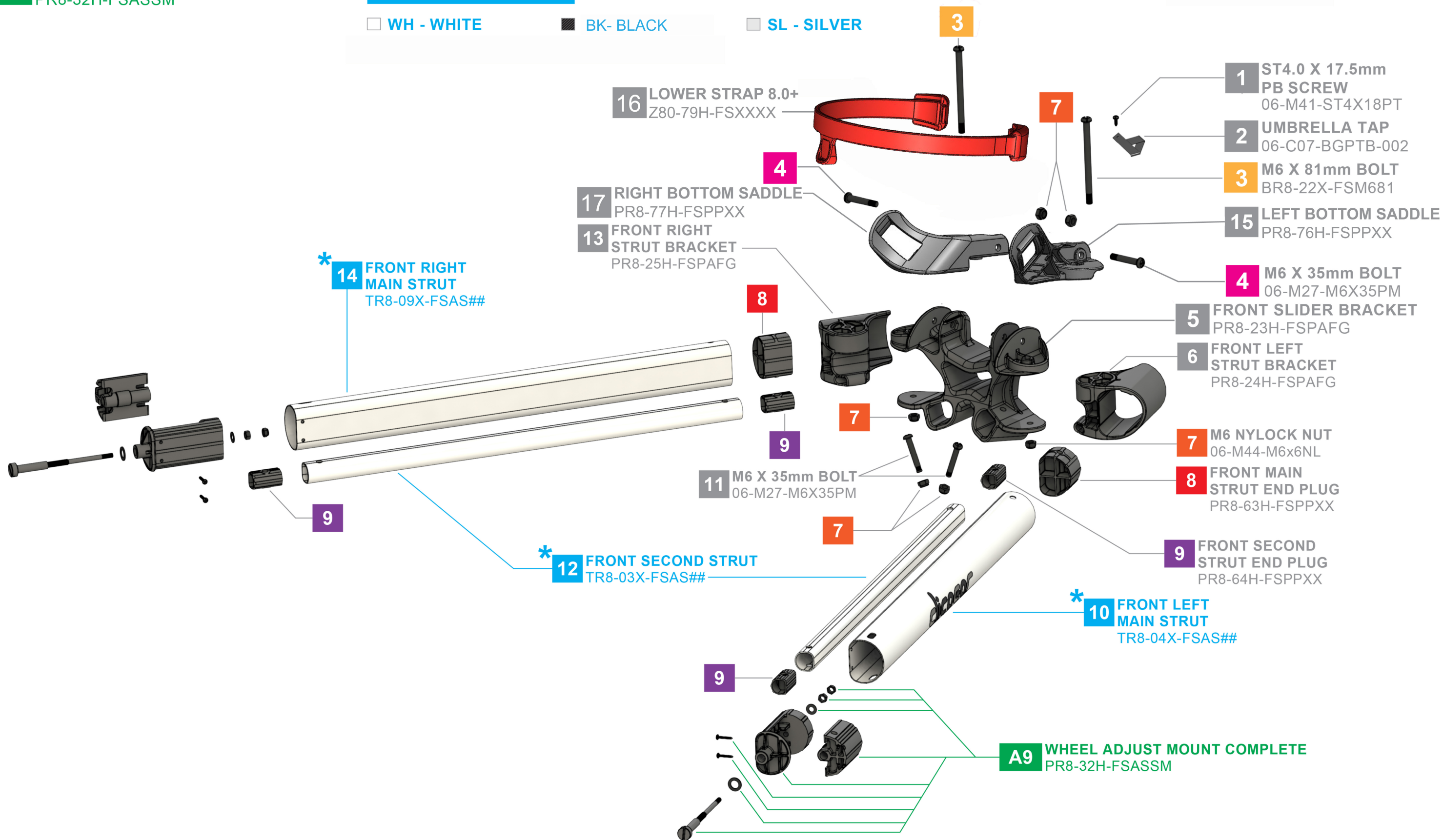

16 LOWER STRAP 8.0+  
Z80-79H-FSXXX

17 RIGHT BOTTOM SADDLE  
PR8-77H-FSPPPXX

13 FRONT RIGHT  
STRUT BRACKET  
PR8-25H-FSPAFG

\* 14 FRONT RIGHT  
MAIN STRUT  
TR8-09X-FSAS##

\* 12 FRONT SECOND STRUT  
TR8-03X-FSAS##

\* 10 FRONT LEFT  
MAIN STRUT  
TR8-04X-FSAS##

1 ST4.0 X 17.5mm  
PB SCREW  
06-M41-ST4X18PT

2 UMBRELLA TAP  
06-C07-BGPTB-002

3 M6 X 81mm BOLT  
BR8-22X-FSM681

15 LEFT BOTTOM SADDLE  
PR8-76H-FSPPPXX

4 M6 X 35mm BOLT  
06-M27-M6X35PM

5 FRONT SLIDER BRACKET  
PR8-23H-FSPAFG

6 FRONT LEFT  
STRUT BRACKET  
PR8-24H-FSPAFG

7 M6 NYLOCK NUT  
06-M44-M6x6NL

8 FRONT MAIN  
STRUT END PLUG  
PR8-63H-FSPPPXX

9 FRONT SECOND  
STRUT END PLUG  
PR8-64H-FSPPPXX

A9 WHEEL ADJUST MOUNT COMPLETE  
PR8-32H-FSASSM